

# Low-Voltage Wallstations



The Low-Voltage Wallstations with integrated LED indicators are available in a range of configurations for customized light level control. These Wallstations enable convenient control and desired lighting levels and work with the Encelium® Extend Networked and Encelium Edge™ Standalone Wireless Light Management Systems via wired<sup>1</sup> or wireless<sup>2</sup> networks.

These low-voltage Wallstations obtain their operating power via GreenBus II wire and are intended to be installed onto an electrical box with functionality options dependent on the model installed.

**Two-Button Wallstation (EN-WS-2B):** The 2-Button Wallstation is a single-zone lighting controller ideal for small conference rooms, private offices and other spaces where multi-zone control is not required. A short press of the upper/lower buttons turns lighting ON/OFF, while a “press and hold” dims lighting up or down.

**Scene Dimming Wallstation (SCX):** The multi-scene, single-zone dimming Wallstation provides customized light level control in areas such as boardrooms, conference rooms, private offices and other areas requiring architectural dimming. The SCX allows the user to select pre-programmed light levels or “scenes” with the push of a button. Scene configuration can be changed via the System Software.

**Zone Wallstation (ZCX)<sup>3</sup>:** The multi-zone Wallstation offers software-configurable lighting control that provides ON/OFF switching for multiple lighting zones. It is generally located at entry points to a floor or department and is used to “activate” or “de-activate” a lighting zone. The zone status is indicated by an LED display with white indicating ON and blue indicating OFF.

## System Compatibility

- Works with the Encelium® Extend Networked Light Management System
- Works with the Encelium Edge™ Standalone Wireless Light Management System

## Key Features & Benefits

- Setup and monitoring via software
- Sleek aesthetic design
- Wired and Hybrid Architecture support - No batteries required
- Easy set-up
- Wide range of configurations to support design needs
- Proximity sensing illuminates LEDs of current setting when motion is sensed



Our Brand

ENCELIUM

OSRAM

## Specifications

### Software

- Mapping/Remapping
- Combined scene & zone in one Wallstation<sup>3</sup>
- Application of custom commands to individual Wallstation buttons<sup>3</sup>

### Environmental

- Operating Temperature Range: 14° – 104°F (-10° – 40°C)
- Relative Humidity: 5% – 95% RH non-condensing; rated for indoor locations

### Mechanical

- Meets NEMA WD 6 and WD 1 specifications
- Dimensions (H x W x D):
  - J-Box Mounted: 4.5 x 2.76 x 0.94 inch (114.3 x 70.1 x 23.9 mm)

### Mounting Options

- Standard size wall box mount
- On mounting brackets for low voltage devices
- Support for “Decorator” style wall plate installation

### Regulatory

- cULus Listed (UL 916)
- Rated for dry locations; RoHS compliant
- FCC Part 15/ICES-003
- Electromagnetic requirements:
  - EN 61000-4-2
  - EN 61000-4-4
  - EN 61000-4-5

## Ordering Information

### General Lighting Wallstations

Item Number	Ordering Code	Works with Encelium Extend Networked LMS	Works with ENCELIUM EDGE Standalone LMS	Communication Network	Modifiers
45579	EN-WS-2B-GB2-WH	Yes	Yes	GreenBus II®	White - WH
45580	EN-WS-SC3-GB2-WH	Yes	Yes	GreenBus II	White - WH
45592	EN-WS-SC5-GB2-WH	Yes	Yes	GreenBus II	White - WH
45581	EN-WS-ZC3-GB2-WH	Yes	No	GreenBus II	White - WH
45593	EN-WS-ZC6-GB2-WH	Yes	No	GreenBus II	White - WH
56344	EN-WS-4B-GB2-WH	Yes	No	GreenBus II	White - WH
45620	EN-WS-2B-GB2-IV	Yes	No	GreenBus II	Ivory - IV
45621	EN-WS-SC3-GB2-IV	Yes	No	GreenBus II	Ivory - IV
45622	EN-WS-SC5-GB2-IV	Yes	No	GreenBus II	Ivory - IV
45623	EN-WS-ZC3-GB2-IV	Yes	No	GreenBus II	Ivory - IV
45624	EN-WS-ZC6-GB2-IV	Yes	No	GreenBus II	Ivory - IV
45625	EN-WS-2B-GB2-GR	Yes	No	GreenBus II	Gray - GR
45626	EN-WS-SC3-GB2-GR	Yes	No	GreenBus II	Gray - GR
45627	EN-WS-SC5-GB2-GR	Yes	No	GreenBus II	Gray - GR
45628	EN-WS-ZC3-GB2-GR	Yes	No	GreenBus II	Gray - GR
45629	EN-WS-ZC6-GB2-GR	Yes	No	GreenBus II	Gray - GR
45640	EN-WS-2B-GB2-BL	Yes	No	GreenBus II	Black - BL
45641	EN-WS-SC3-GB2-BL	Yes	No	GreenBus II	Black - BL
45642	EN-WS-SC5-GB2-BL	Yes	No	GreenBus II	Black - BL
45643	EN-WS-ZC3-GB2-BL	Yes	No	GreenBus II	Black - BL
45644	EN-WS-ZC6-GB2-BL	Yes	No	GreenBus II	Black - BL

### Tunable White Wallstations

The 3 Scene Tunable White wallstation offers the ability to adjust intensity and color temperature from a single wallstation. The scene buttons with engravings like Warm, Neutral, Cool make it intuitive for occupants.

Item Number	Ordering Code	Works with Encelium Extend Networked LMS	Works with ENCELIUM EDGE Standalone LMS	Communication Network	Modifiers
56338	EN-WS-TWSC3-GB2-WH	Yes	No	GreenBus II	White - WH

### Shade Control Wallstations

The 3 Scene Shade Control wallstation offers the ability to adjust lights and shades from a single wallstation. The scene buttons allow for recalling specific lighting level and shade position based on user requirements.

Item Number	Ordering Code	Works with Encelium Extend Networked LMS	Works with ENCELIUM EDGE Standalone LMS	Communication Network	Modifiers
56342	EN-WS-SHSC3-GB2-WH	Yes	No	GreenBus II	White - WH

## Button Kits

The button Kits provide the ability for field replacement.

Item Number	Ordering Code	Works with Encelium Extend Networked LMS	Works with ENCELIUM EDGE Standalone LMS	Contains	Modifiers
56339	EN-TW-BT01-ZC3-WH	Yes	No	3 - Tunable White Buttons	White - WH
56343	EN-SH-BT01-ZC3-WH	Yes	No	3 - Shade Control Buttons	White - WH
56346	EN-LTG-BT01-SC5-WH	Yes	Yes	5 - Single Height Buttons	White - WH
56347	EN-APP-BT01-SC5-WH	Yes	Yes	5 - Single Height Buttons	White - WH

## Button Kits (cont.)

The button Kits provide the ability for field replacement.

### Custom Button Kits

Item Number	Ordering Code	Works with Encelium Extend Networked LMS	Works with ENCELIUM EDGE Standalone LMS	Contains	Modifiers
45596	EN-WS-2B-CBK-WH	Yes	Yes	2 - Triple Height Buttons	White - WH
45597	EN-WS-SC3-CBK-WH	Yes	Yes	3 - Single Height Buttons	White - WH
45598	EN-WS-SC5-CBK-WH	Yes	Yes	5 - Single Height Buttons	White - WH
45599	EN-WS-ZC3-CBK-WH	Yes	No	3 - Double Height Buttons	White - WH
45600	EN-WS-ZC6-CBK-WH	Yes	No	6 - Single Height Buttons	White - WH

## Dimensions

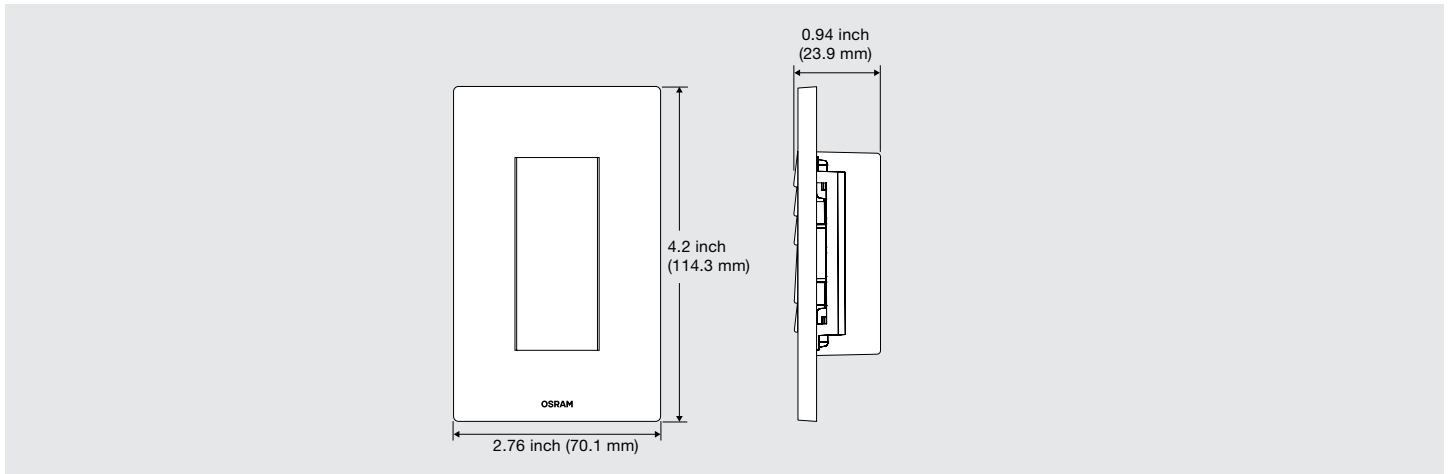

## Configuration Options

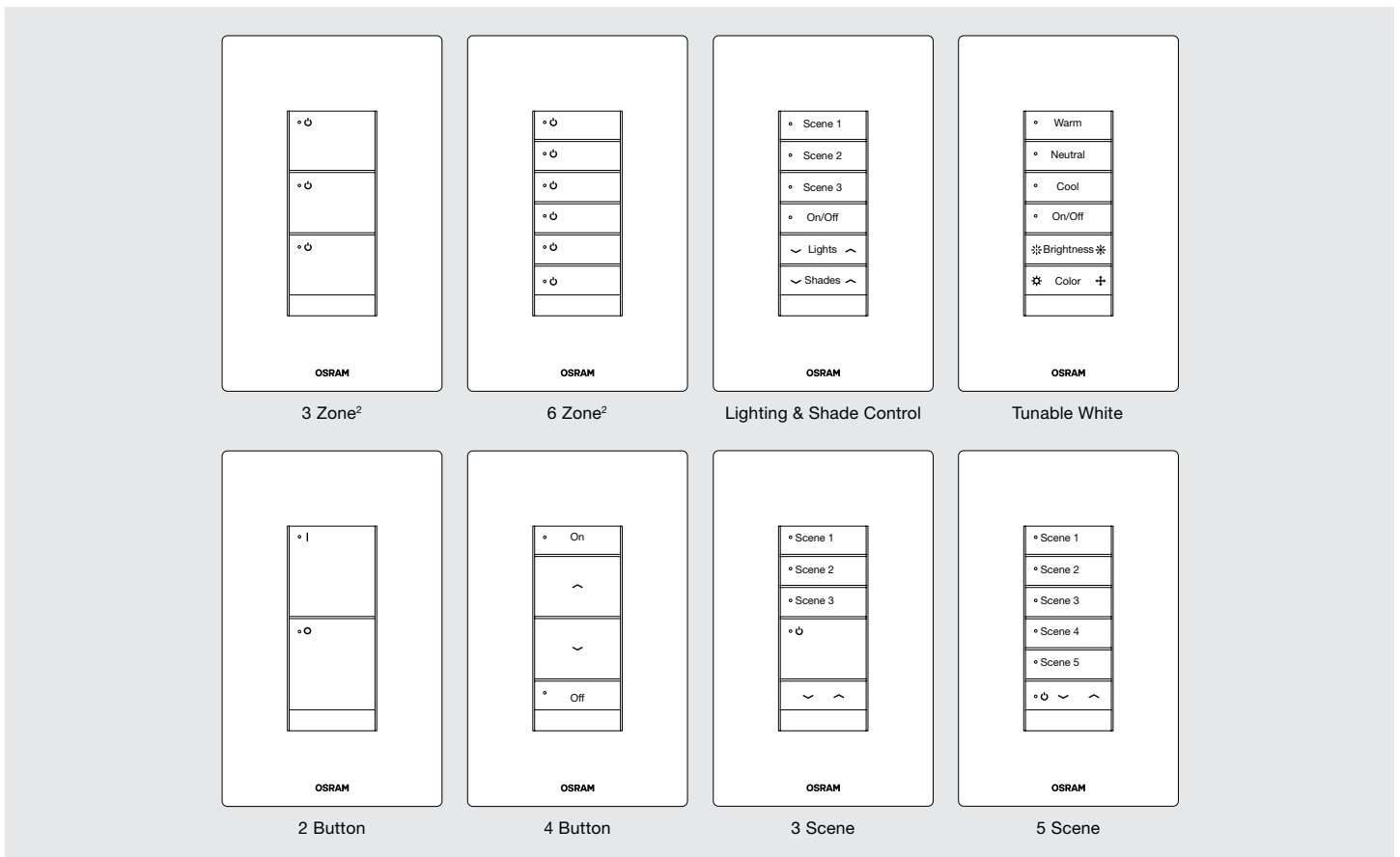

## Button Kit Options

Each part number comes with the three button kits shown to allow flexibility to replace buttons on an existing wallstation.

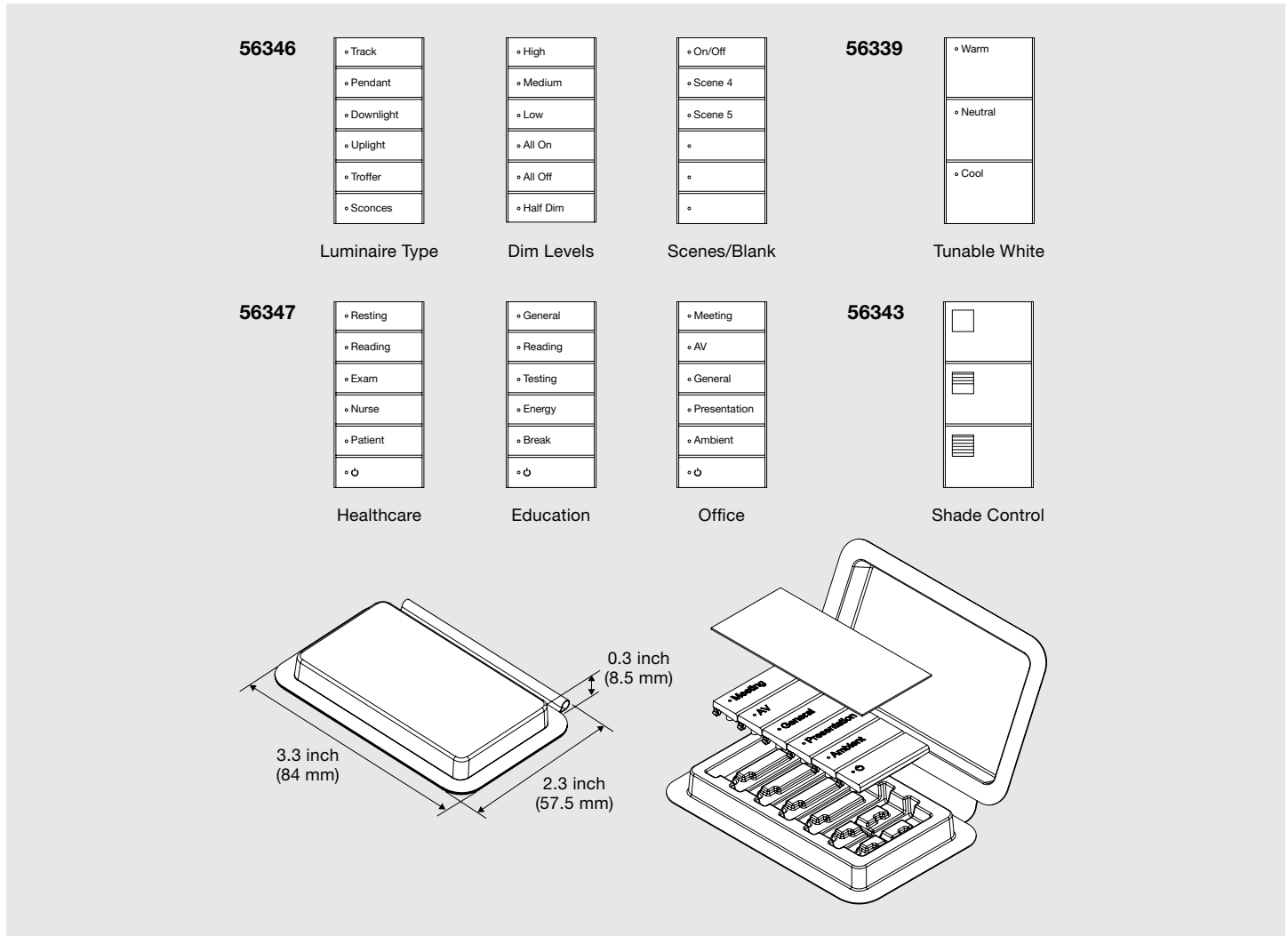

## Warranty

For warranty details, refer to the full warranty documentation at [www.encelium.com](http://www.encelium.com).

### Footnotes:

1 Used in wired version of the Encelium® Extend Networked Lighting Management System. When used in the wireless version of the Encelium Extend Networked Lighting Management System or Encelium Edge™ Systems, GreenBus II wire is utilized only for connecting a wired Wallstation to WALC.

2 Mesh network is utilized in wireless version of the Encelium Extend Networked Lighting Management System & Encelium Edge Systems.

3 Available with the Encelium Extend Networked Lighting Management System.

4 To order custom buttons, contact your local Encelium sales representative.

OSRAM SYLVANIA Inc.  
374 Congress Street  
Suite 600  
Boston, MA 02210 USA  
1-877-636-5267  
[www.encelium.com](http://www.encelium.com)

OSRAM is a registered trademark of OSRAM GmbH.  
Encelium Extend and GreenBus II are registered trademarks of OSRAM SYLVANIA Inc.  
ENCELIUM EDGE is a trademark of OSRAM SYLVANIA Inc.  
Specifications subject to change without notice.  
© 2018 OSRAM SYLVANIA Inc.

**OSRAM**